

CAME

CE

119RU01EN

COMPLETE SYTEM FOR RADIO COMMANDS



INSTALLATION MANUAL

TRA08

English

EN

"IMPORTANT INSTALLATION SAFETY INSTRUCTIONS"

"WARNING: IMPROPER INSTALLATION MAY RESULT IN SERIOUS HARM. PLEASE FOLLOW ALL INSTALLATION INSTRUCTIONS"

"THIS MANUAL IS INTENDED ONLY FOR PROFESSIONAL INSTALLERS OR OTHER COMPETENT INDIVIDUALS"



Legend of symbols



This symbol shows parts which must be read with care.



This symbol means the parts which describe safety issues.



This symbol tells you what to tell the end-user.

2.1 Intended use

2.1 Intended use

The TRA08 kit is for commanding, only by radio, up to four different operators.

Any installation and use other than that specified in this manual is forbidden.



4 Description

Engineered and built entirely by CAME S.p.A.

The kit comprises:

- 1 **RBE42**: 230 V outdoor four-channel radio receiverV.
5 A relay.
- 2 **TOP-434EE** : four-channel transmitters;
- 1 **TOP-A433N**: antenna with fastening bracket;
- 1 **TOP-RG58**: co-axial antenna cable (5 m).

One radio command to control four systems:

- arm the alarm;
- turn on outdoor lights;
- turn on the lawn sprinkler system;
- close the shutters.

5 Installation

5.1 Preliminary checks



Cut off the main power before acting inside the equipment.

- Do not install multiple receivers at less than 4-5 m from each other, to prevent functioning anomalies
- The receiver must always be fitted with an antenna. Possibly place the antenna as high as possible from the ground and far from any metal and reinforced concrete structures.

5.2 Tools and equipment

Make sure you have all the tools and materials needed to carry out the installation in total safety and in accordance with current regulations. Here are some examples.

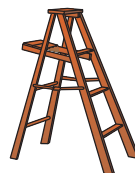
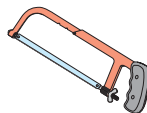
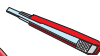

6 RBE42

4-channel outdoor radio receiver.

The board is powered by 230 V A.C.

For each single output you can select the following features :

- maintained action command;
- bistable (switch);
- fixed 3 second timed monostable*;
- fixed 5 minute timed monostable*.

TECHNICAL DATA	
Power supply	230V A.C.
Insulation class	□
Material	ABS
Protection rating	IP54

⚠ Warning! Cut off the main power before acting inside the equipment.

6.1 Dimensions

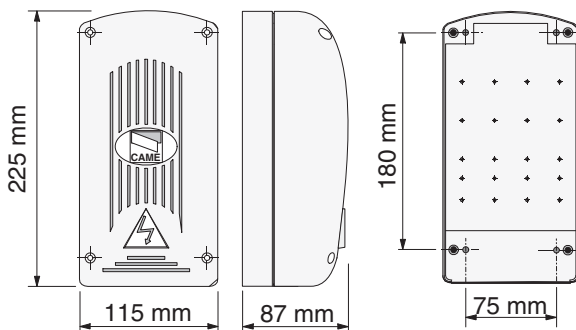

6.2 Main components

1. Control unit fuse (315 mA - quick)
2. Buttons to memorise radio code
3. Line fuse (125 mA - quick)
4. 230 V power supply terminals
5. Memorisation underway LED
6. AF43S radio-frequency card
7. Functions selection Dip switch
8. Antenna connection terminals
9. Systems connection terminals (relay rated max: 10A)

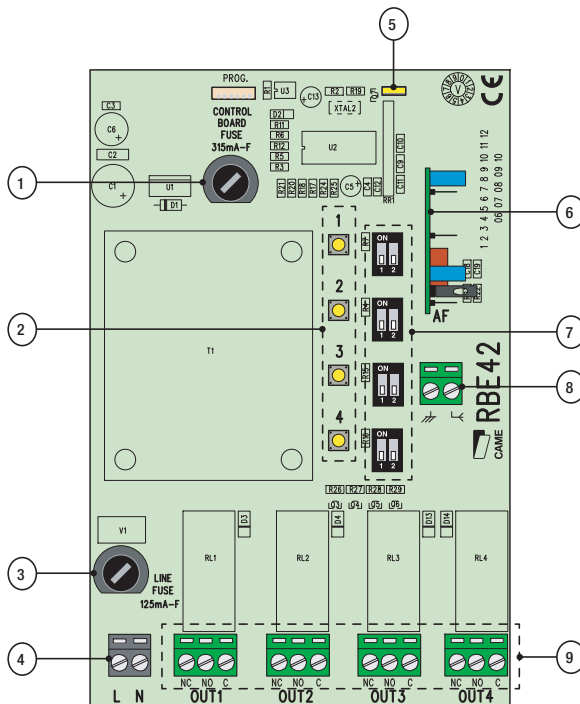

7 TOP-434EE

Multi-user channel transmitter

TECHNICAL DATA	
Frequency	AM 433.92 MHz
Batteries	two CR2016 - 3 V DC Lithium
Power draw when transmitting	12 mA
Effective to	50 ÷ 150 m
Code combination	4096
Weight	16 G

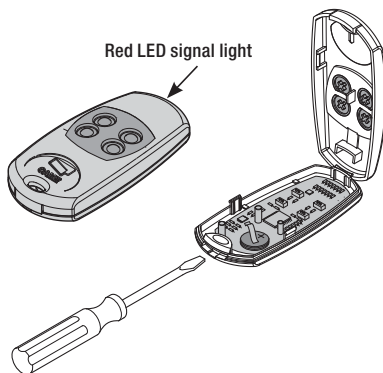

8 TOP-433N

8.1 Main components

1. Antenna rod
2. Upper container part
3. Circuit
4. Lower container part
5. Antenna/ bracket fastening screws
6. Fastening bracket

8.2 Mounting description

- Fasten the lower part of the container to the anchoring bracket - use the supplied screws;
- connect the RG58 coaxial cable to the antenna circuit;
- insert the circuit into the lower part of the container through the apposite hole on the circuit itself;
- fit the two containers together and screw in the shaft.

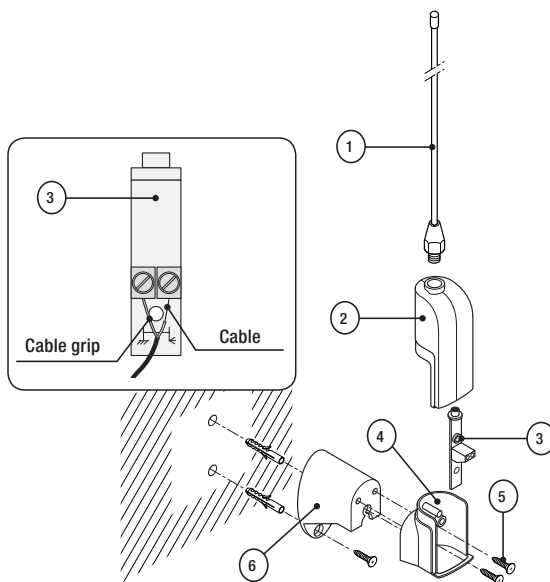

9 Activating the radio command

Antenna

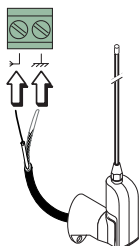

Connect RG58 antenna cable to the apposite terminals.

Radio frequency card

Plug in the radio-frequency card onto the electronic board AFTER CUTTING OFF THE MAIN POWER SUPPLY (or disconnecting the emergency batteries).

N.B.: The electronic card recognises the radio-frequency card only when it is powered up.

Basic Card

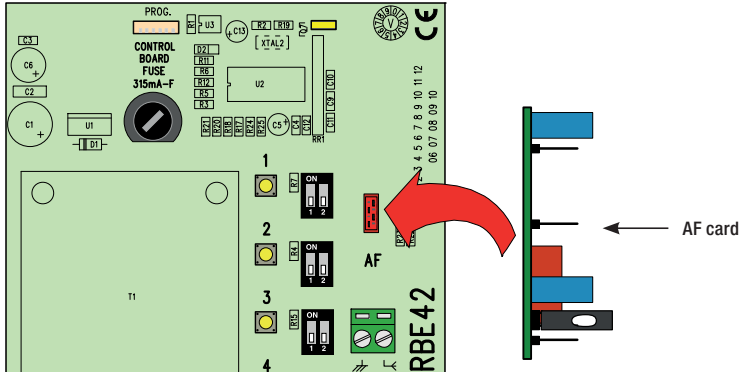

10 Electrical connections

- Connect the devices to command onto the 4 outputs, selecting the feature you want for each one;
- connect the antenna onto the relative terminal with the RG58 cable (see p. 4);
- power the card with a 230 V line

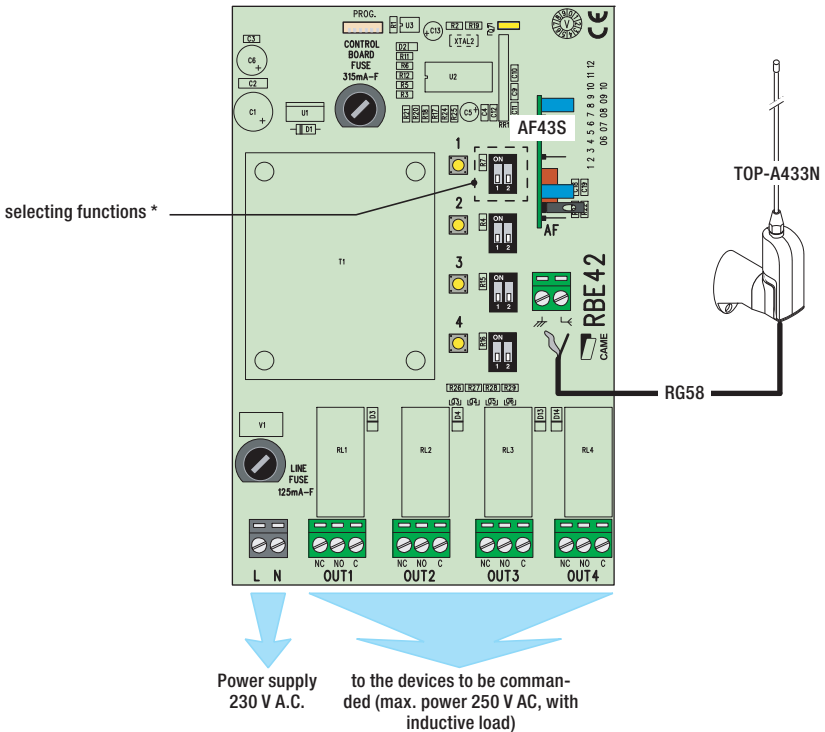

* 10.1 Selecting functions (for each single output)

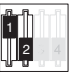
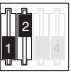
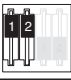
 <p>ON</p> <p>OFF</p>	<p>"Maintained action" feature : the relay action lasts as long as the transmitter button is pressed .</p>
 <p>ON</p> <p>OFF</p>	<p>Fixed 3 second timed monostable": once the transmitter button is released the relay action lasts 3 seconds.</p>
 <p>ON</p> <p>OFF</p>	<p>Bistable (switch): repeatedly pressing the transmitter button will turn on and off the relay continuously as if it were a switch.</p>
 <p>ON</p> <p>OFF</p>	<p>Fixed 5 minute timed monostable: once the transmitter button is released the relay action lasts 5 minutes.</p>

11 Duplicating a transmitter

Duplication must be done because each of the transmitters is made with different codes.

1. Simultaneously press the two buttons until the LED flashes more quickly;
 2. - now press the button you wish to activate (the LED lights up);
 3. with 10 seconds, rest the active transmitter against it back part and press the button that needs duplicating for a few seconds.
- Once memorisation is complete, the LED will flash 3 times and the transmitter will be ready for use.
Repeat points 1, 2 and 3 for the remaining buttons.

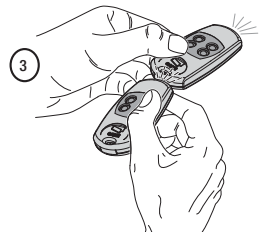
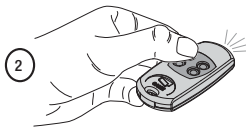
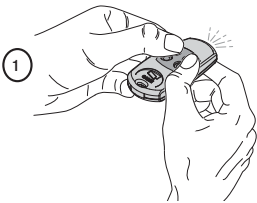

12 Memorising the code onto the receiver

Keep memorisation button pressed until the LED flashes, press the transmitter button to send the code.
The LED will stay ON to confirm memorisation is OK.
Perform the same procedure for each exit (also see examples on the following pages).

- 1 => OUT1
- 2 => OUT2
- 3 => OUT3
- 4 => OUT4

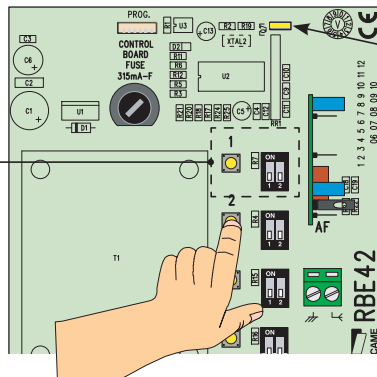

LED signal light
radio code



13 Application example

P1 => 1 => OUT1

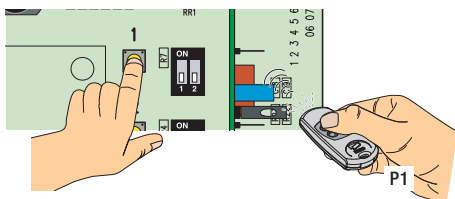

P2 => 2 => OUT2

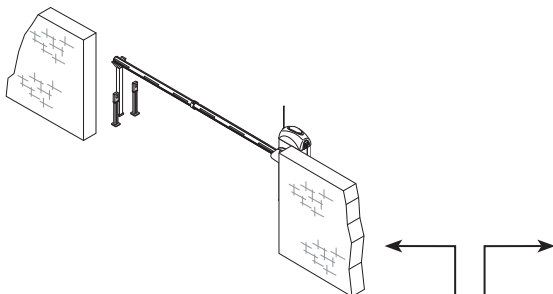
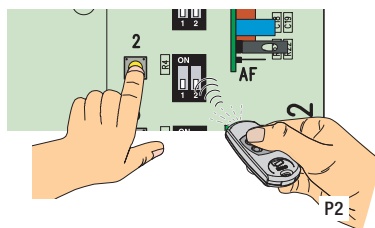

Apartment block barrier

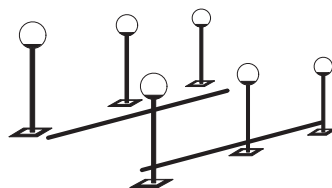

Timed walkway lights

Sectional door to garage zone

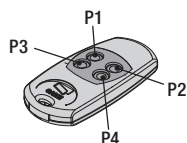
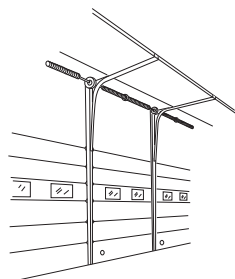

Timed entrance-stairs lights

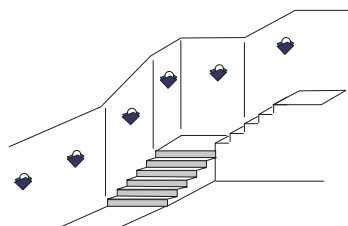

P3 => 3 => OUT3

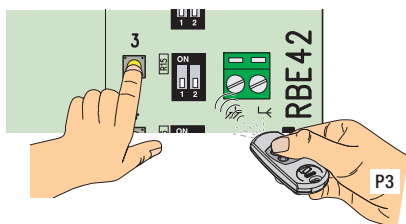

P4 => 4 => OUT4

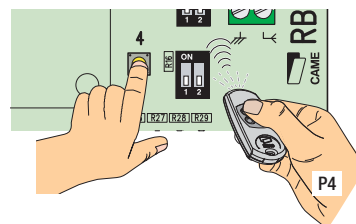

14 Dismantling and disposal

 CAME S.p.A. employs a UNI EN ISO 14001 certified and compliant environmental protection system at its plants, to ensure that environmental safeguarding. We ask you to keep protecting the environment, as CAME deems it to be one of the fundamental points of its market operations strategies, by simply following these brief guidelines when disposing:

DISPOSING THE PACKING MATERIALS

The packing components (cardboard, plastic, etc.) are solid urban waste and may be disposed of without any particular difficulty, by simply separating them so that they can be recycled.

Before actions it is always advisable to check the pertinent legislation where installation will take place.

DO NOT DISPOSE OF IN NATURE!

DISPOSING OF THE PRODUCT

Our products are made using different types of materials. The majority of them (aluminium, plastic, iron, electric cables) can be considered to be solid urban waste. They may be recycled at authorised firms.

Other components (electrical circuit board, remote control batteries etc.) may contain hazardous waste. They must, thus, be removed and turned in to licensed firms for their disposal.

Before acting always check the local laws on the matter.

DO NOT DISPOSE OF IN NATURE!

15 Compliance statement

Declaration **CE** - Came S.p.A. declares that this device conforms with the essential requirements and other pertinent provisions established by directive 1999/5/CE



An original copy is available on request.

CAME
safety & comfort



   
CAME parkare 

CAME S.p.A.

Via Martiri Della Libertà, 15
31030 **Dosson di Casier**
Treviso - Italy

 (+39) 0422 4940
 (+39) 0422 4941

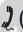
Via Cornia, 1/b - 1/c
33079 **Sesto al Reghena**
Pordenone - Italy

 (+39) 0434 698111
 (+39) 0434 698434

www.came.com